

Topological BGA Cover

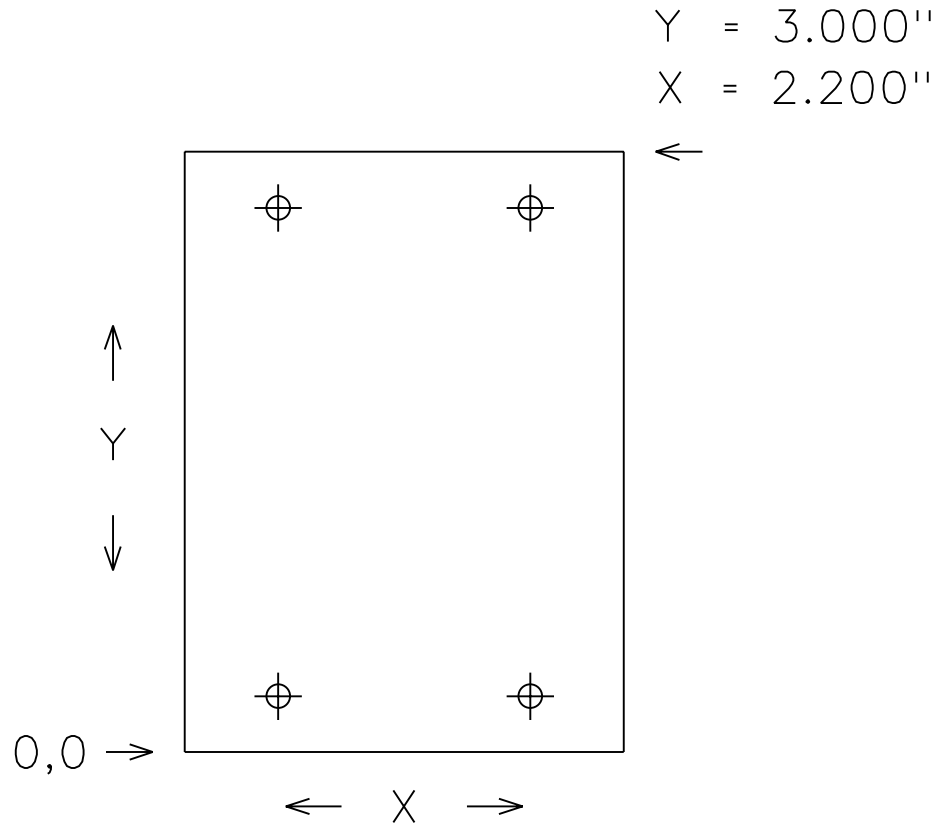

Material: 2.200" by 3.000" 1/8" thick Delrin blank

Holes: 4 body drills for 4-40 machine screws

Hole Locations X,Y wrt the 0,0 Corner:

0.470", 2.720"

1.730", 2.720"

0.470", 0.280"

1.730", 0.280"

The exact size of the Delrin blank does not matter.
Only the relative position of the 4 holes is important.