

Cold Board - Chip Trench Depth Cut - 20 mil Dia. Tool

Center Part of the
Cold Board

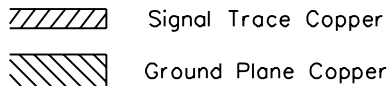
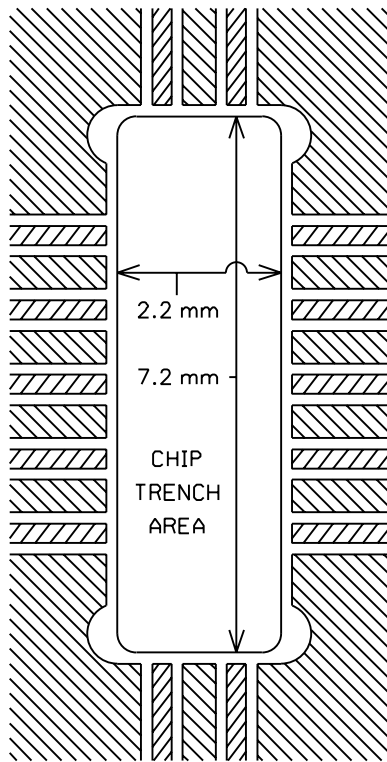

All copper has been held back from the edge of the Chip Trench by 0.15 mm.

Chip Trench Depth Cut - WITHOUT Ears

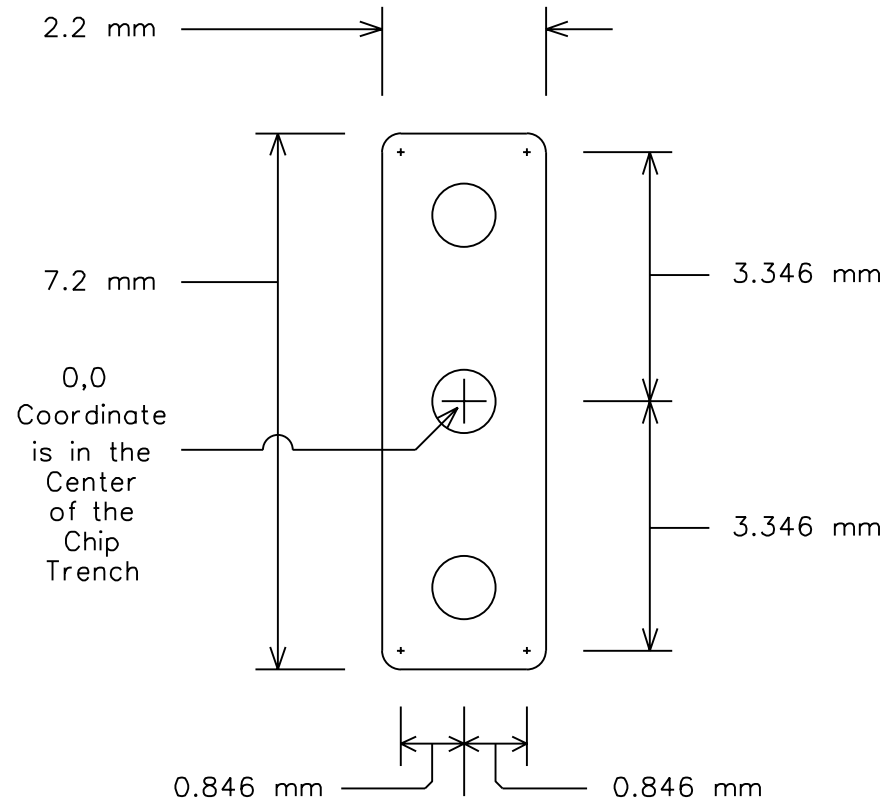

This depth cut is made using a 20 mil diameter end-mill = 0.508 mm diameter.

The four "+" signs mark the limits of the movement of the Center of the 20 mil diameter end-mill while cutting down into the pcb material to make the Rectangular Part of the Chip Trench.