

# Customer Information Sheet

DRAWING No.: M80-FCXXXFI-XX-XXXXL

IF IN DOUBT - ASK

©

NOT TO SCALE

THIRD ANGLE PROJECTION

ALL DIMENSIONS IN mm

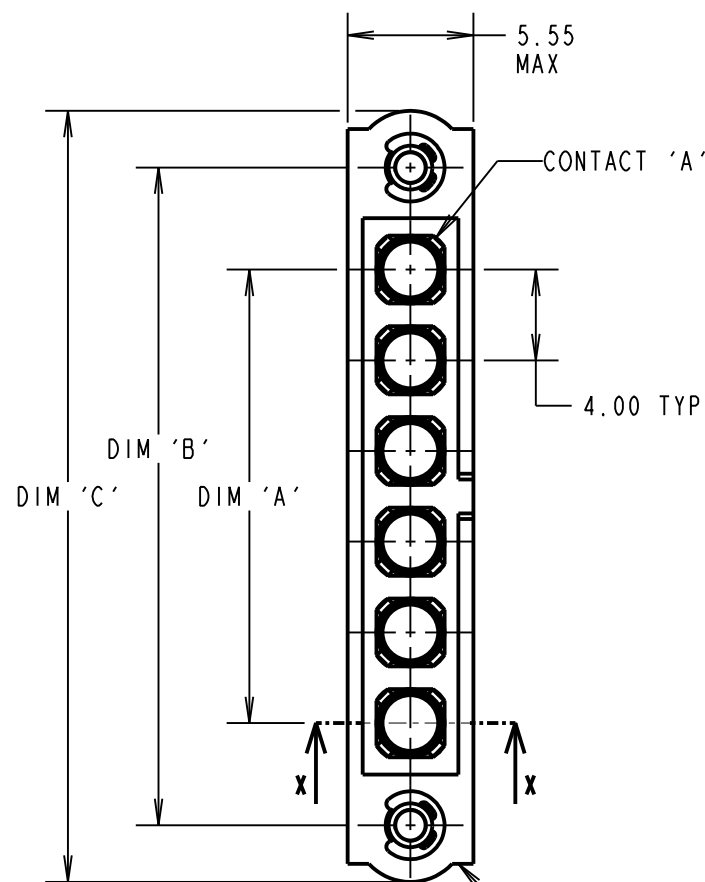

FEMALE MOULDING (1-OFF) - SEE ORDER CODE FOR TOTAL NUMBER OF CONTACTS

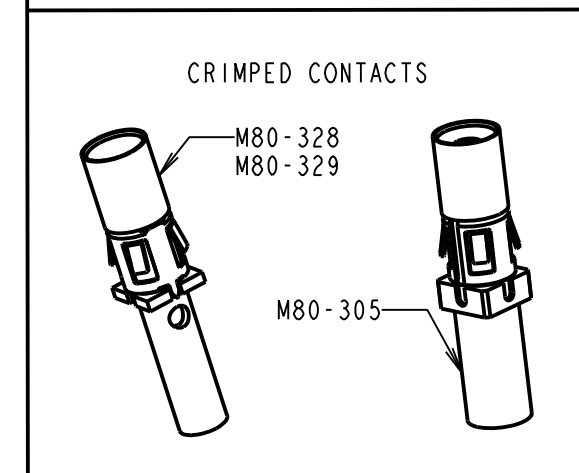
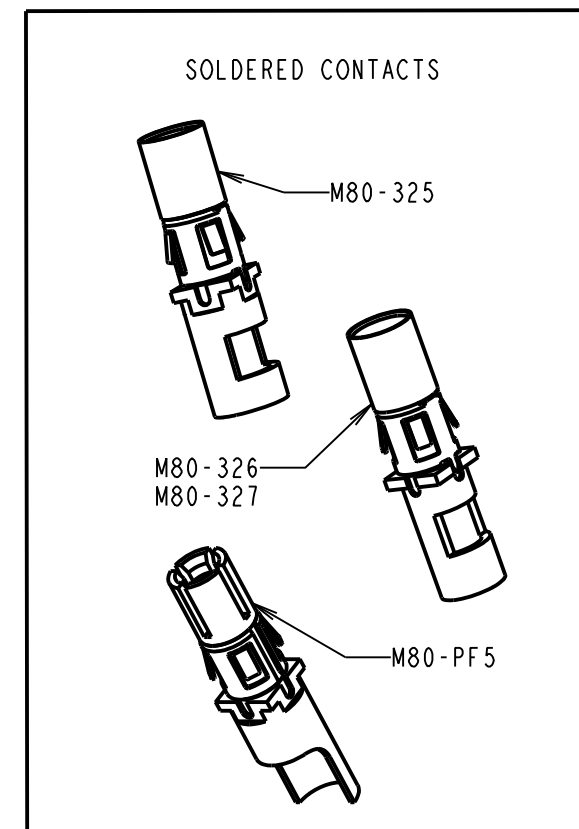
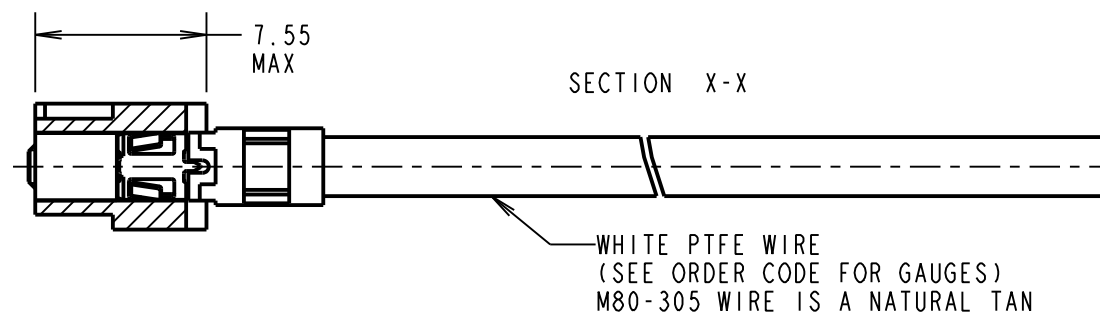
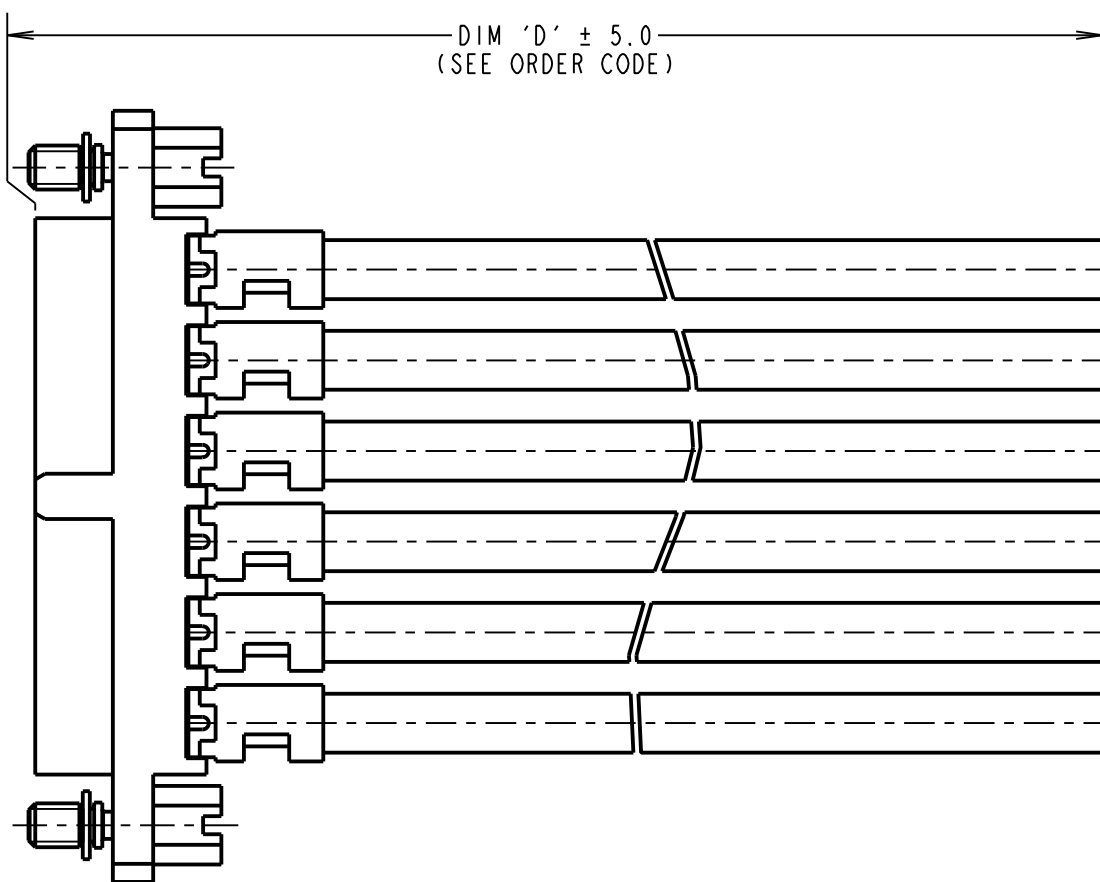

- NOTES:
- CABLE ASSEMBLIES ARE PACKED IN BAGS OF 10.
  - FOR COMPLETE SPECIFICATION SEE COMPONENT SPECIFICATION CO05XX AND C049XX (LATEST ISSUES).

DIMENSION	MEASUREMENT
DIM 'A'	(4 x No. OF CONTACTS) - 4.00
DIM 'B'	(4 x No. OF CONTACTS) + 5.00
DIM 'C'	(4 x No. OF CONTACTS) + 10.0

EXAMPLE PART No.:  
 2 CONTACT CONNECTOR WITH 300mm OF 10AWG WIRE = M80-FCPF5FI-02-0300L  
 12 CONTACT CONNECTOR WITH 150mm OF 12AWG WIRE = M80-FC325FI-12-0150L

## ORDER CODE: M80-FCXXXFI-XX-XXXXL

- POWER CONTACT: \_\_\_\_\_
- 305 = COAX CONTACT CRIMP RG178 M80-305
  - 325 = POWER CONTACT SOLDER 12AWG M80-325
  - 326 = POWER CONTACT SOLDER 14AWG M80-326
  - 327 = POWER CONTACT SOLDER 16AWG M80-327
  - 328 = POWER CONTACT CRIMP 18AWG M80-328
  - 329 = POWER CONTACT CRIMP 20AWG M80-329
  - PF5 = POWER CONTACT SOLDER 10AWG M80-PF5

- DIM 'D' LENGTH: \_\_\_\_\_
- 0060 = 60mm MIN
  - 9999 = 9999mm MAX
  - (SEE TABLE FOR EXAMPLES)

- STOCKED CABLE LENGTHS:
- 0150 = 150mm
  - 0300 = 300mm
  - 0450 = 450mm

TOTAL No. OF CONTACTS: \_\_\_\_\_  
 02 TO 12

RTP	2	26.04.19	21886
NAME	ISS.	DATE	C/NOTE
APPROVED: R.PORTLOCK			
CHECKED: S.BENNETT			
DRAWN: F.MCGOWAN			
CUSTOMER REF.:			
ASSEMBLY DRG:			

# HARWIN

www.harwin.com  
 technical@harwin.com

THIS DRAWING AND ANY INFORMATION OR DESCRIPTIVE MATTER SET OUT HEREON ARE CONFIDENTIAL AND COPYRIGHT PROPERTY OF THE HARWIN GROUP AND MUST NOT BE DISCLOSED, LOANED, COPIED OR USED FOR MANUFACTURING, TENDERING OR FOR ANY OTHER PURPOSE WITHOUT THEIR WRITTEN PERMISSION.

TOLERANCES  
 X. = ±1mm  
 X.X = ±0.50mm  
 X.XX = ±0.20mm  
 X.XXX = ±0.01mm  
 ANGLES = ±5°  
 UNLESS STATED

MATERIAL: SEE ABOVE  
 FINISH: SEE ABOVE  
 S/AREA: mm<sup>2</sup>

TITLE: DATAMATE POWER FEMALE SINGLE-ENDED CABLE ASSEMBLY WITH JACKSCREW

DRAWING NUMBER: M80-FCXXXFI-XX-XXXXL

SHT 2 OF 2