

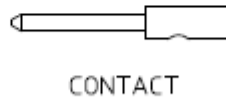

APPLICATION SPECIFICATION

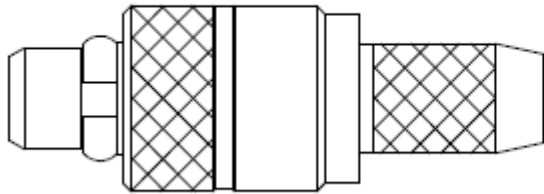

CONTACT

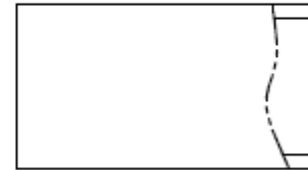

CRIMP FERRULE

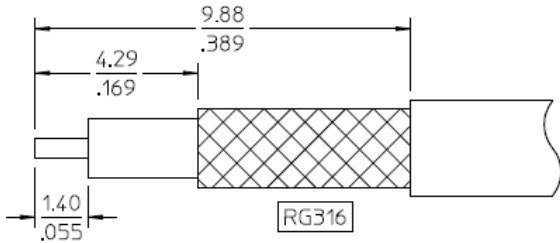

1. STRIP CABLE TO DIMENSIONS SHOWN.

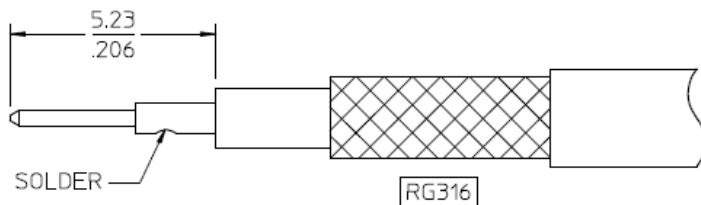

2.1 SLIDE CRIMP TUBE OVER THE CABLE JACKET
 2.2 INSERT CABLE CENTER CONDUCTOR INTO CONTACT AS SHOWN
 2.3 SOLDER CABLE CENTER CONDUCTOR TO CONTACT OF CONNECTOR

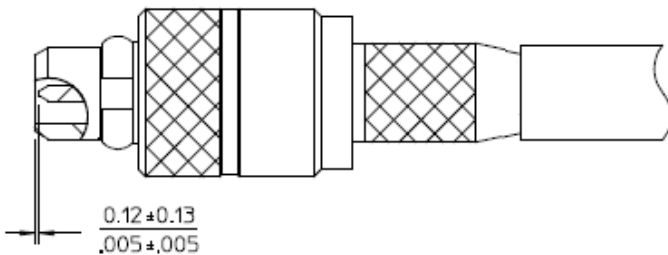

3. INSERT CABLE / CABLE ASSEMBLY INTO CONNECTOR BODY TO THE INTERFACE DIMENSION, AS SHOWN.

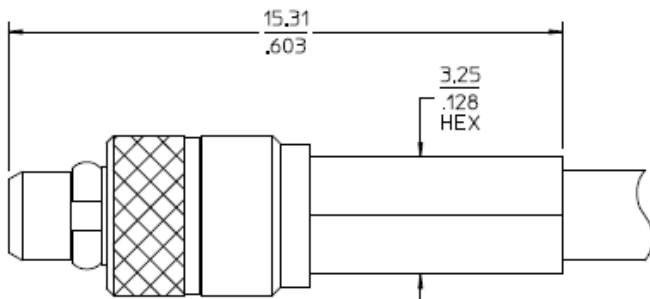

4. SLIDE CRIMP TUBE OVER BRAID UNTIL BOTTOM OCCURS AND CRIMP USING 3.25 HEX. DIE.

REVISION: A	ECR/ECN INFORMATION: EC No: 605901 DATE: 2018/10/15	TITLE: CABLE ASSY INSTRUCTION FOR 73415-125X	SHEET No. 1 of 2
DOCUMENT NUMBER: AS-73597-055	CREATED / REVISED BY: Jason Su	CHECKED BY: JackKH	APPROVED BY: Darry
TEMPLATE FILENAME: APPLICATION_SPEC(SIZE_A4)(V.1).DOC			



APPLICATION SPECIFICATION

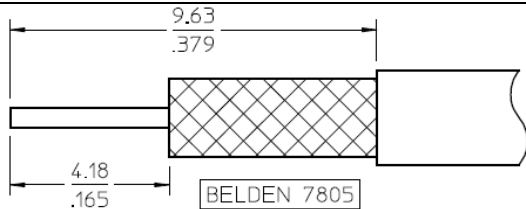
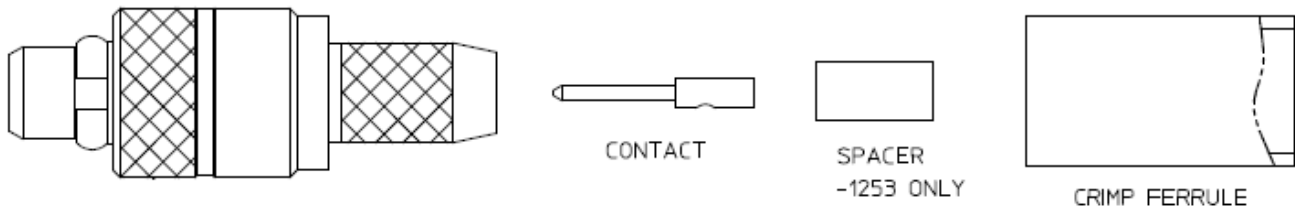

1. STRIP CABLE TO DIMENSIONS SHOWN.

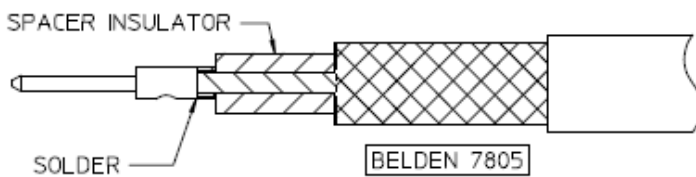

- 2.1 SLIDE CRIMP TUBE OVER THE CABLE JACKET
- 2.2 INSERT SPACER INSULATOR INTO CABLE CENTER CONDUCTOR AS SHOWN
- 2.3 INSERT CABLE CENTER CONDUCTOR INTO CONTACT AS SHOWN
- 2.4 SOLDER CABLE CENTER CONDUCTOR TO CONTACT OF CONNECTOR

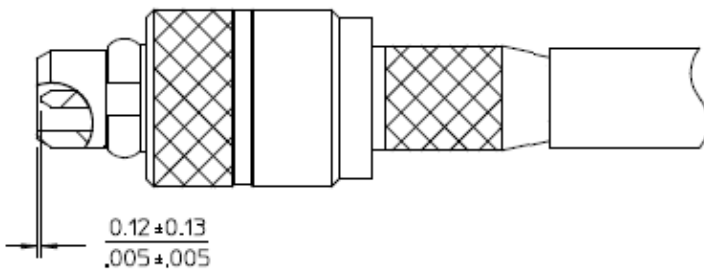

3. INSERT CABLE/CABLE ASSEMBLY INTO CONNECTOR BODY TO THE INTERFACE DIMENSION, AS SHOWN.

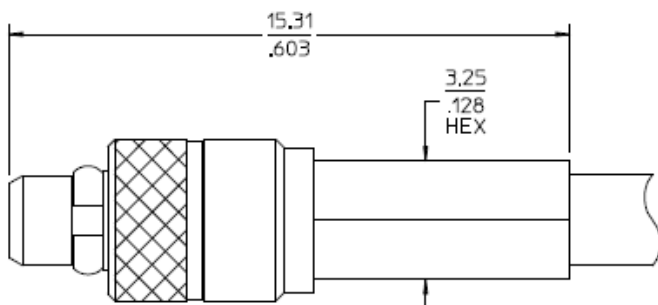

4. SLIDE CRIMP TUBE OVER BRAID UNTIL BOTTOM OCCURS AND CRIMP USING 3.25 HEX. DIE.

REVISION: A	ECR/ECN INFORMATION: EC No: 605901 DATE: 2018/10/15	TITLE: CABLE ASSY INSTRUCTION FOR 73415-125X	SHEET No. 2 of 2
DOCUMENT NUMBER: AS-73597-055	CREATED / REVISED BY: Jason Su	CHECKED BY: JackKH	APPROVED BY: Darry
TEMPLATE FILENAME: APPLICATION_SPEC(SIZE_A4)(V.1).DOC			